



South Ribble Borough: application number FP/2022/0001

To divert public rights of way 9-12-FP12 and 9-12-FP8 to allow the development of the proposed Cuerden strategic employment site (planning application ref: LCC/2022/0044). Land east of Stanifield Lane, North of Clayton Farm, West of Wigan Road, Lostock Hall

FP/2022/0001

Application boundary for planning application LCC/2022/0044

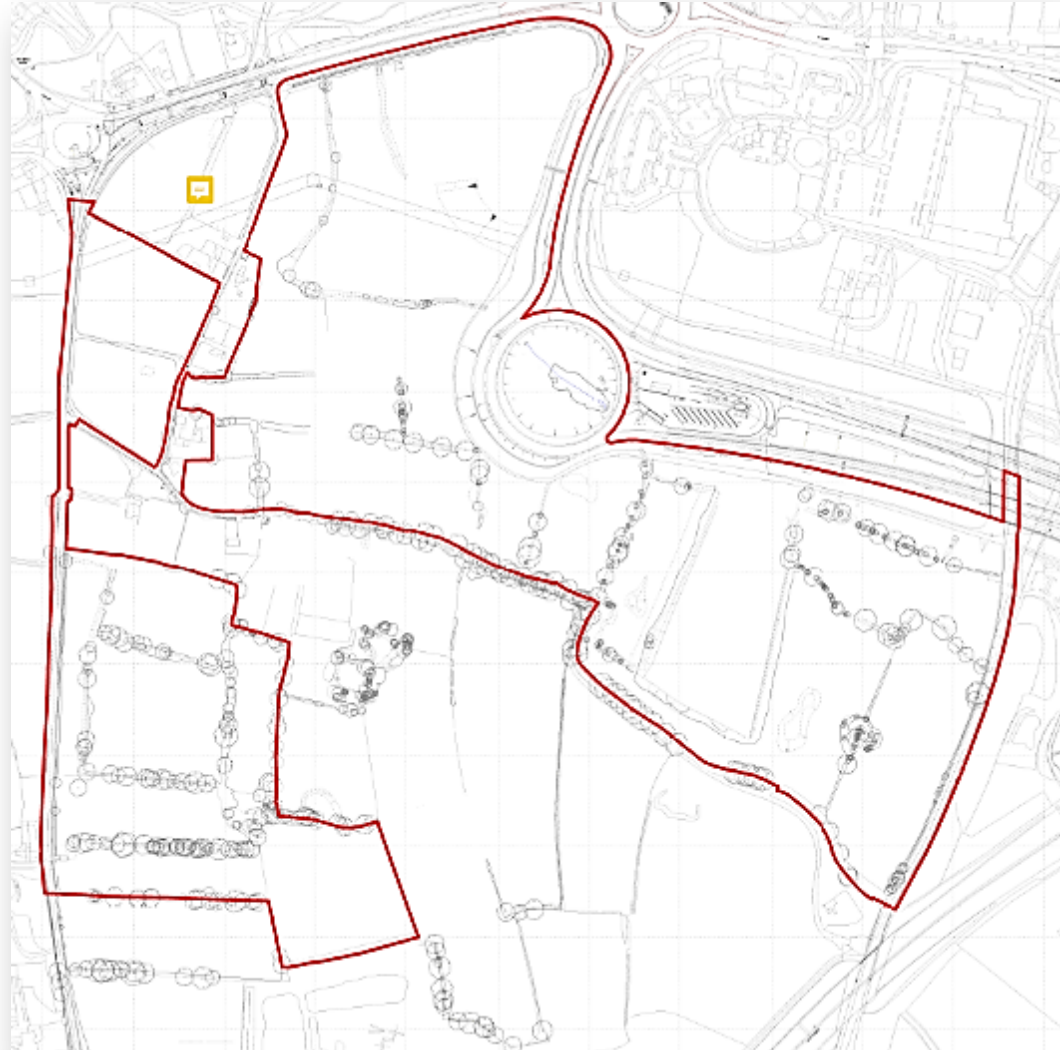

FP/2022/0001 Site Location

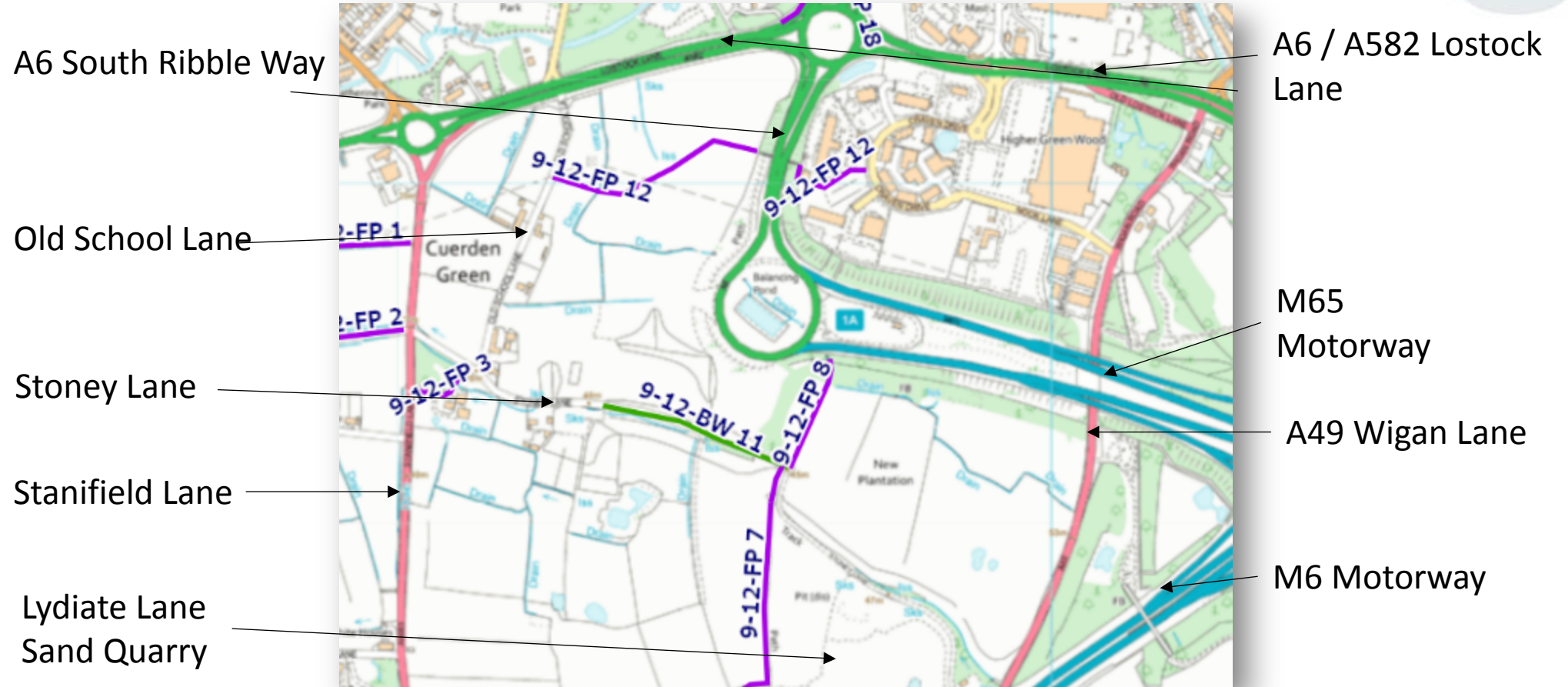

FP/2022/0001

Aerial view (2020)



Proposed site parameters for LCC/2022/0044

Zone E -
Build height up to 13.7m

Zone A -
Build height up to 20m with western restriction at 15m

Zone D -
Build height up to 24.7m with western and northern restriction at 18.6m

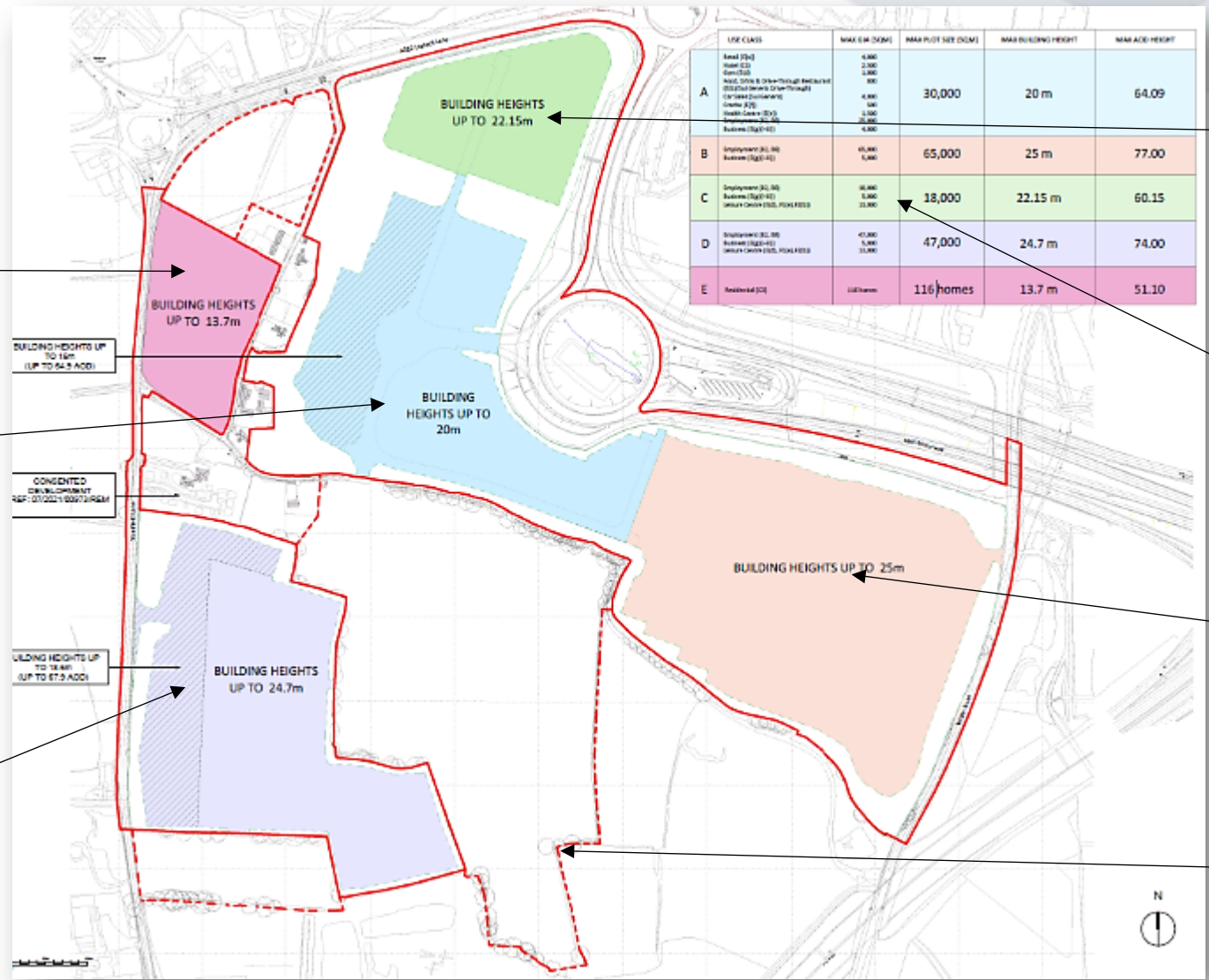

Zone C -
build height up to 22.15m

Maximum plot sizes for different use classes

Zone B - build height up to 25m

Dotted red line denotes wider area of allocated strategic site



Proposed Strategic landscaping for LCC/2022/0044



FP/2022/0001

Proposed diversion of footpath 9-12-FP8

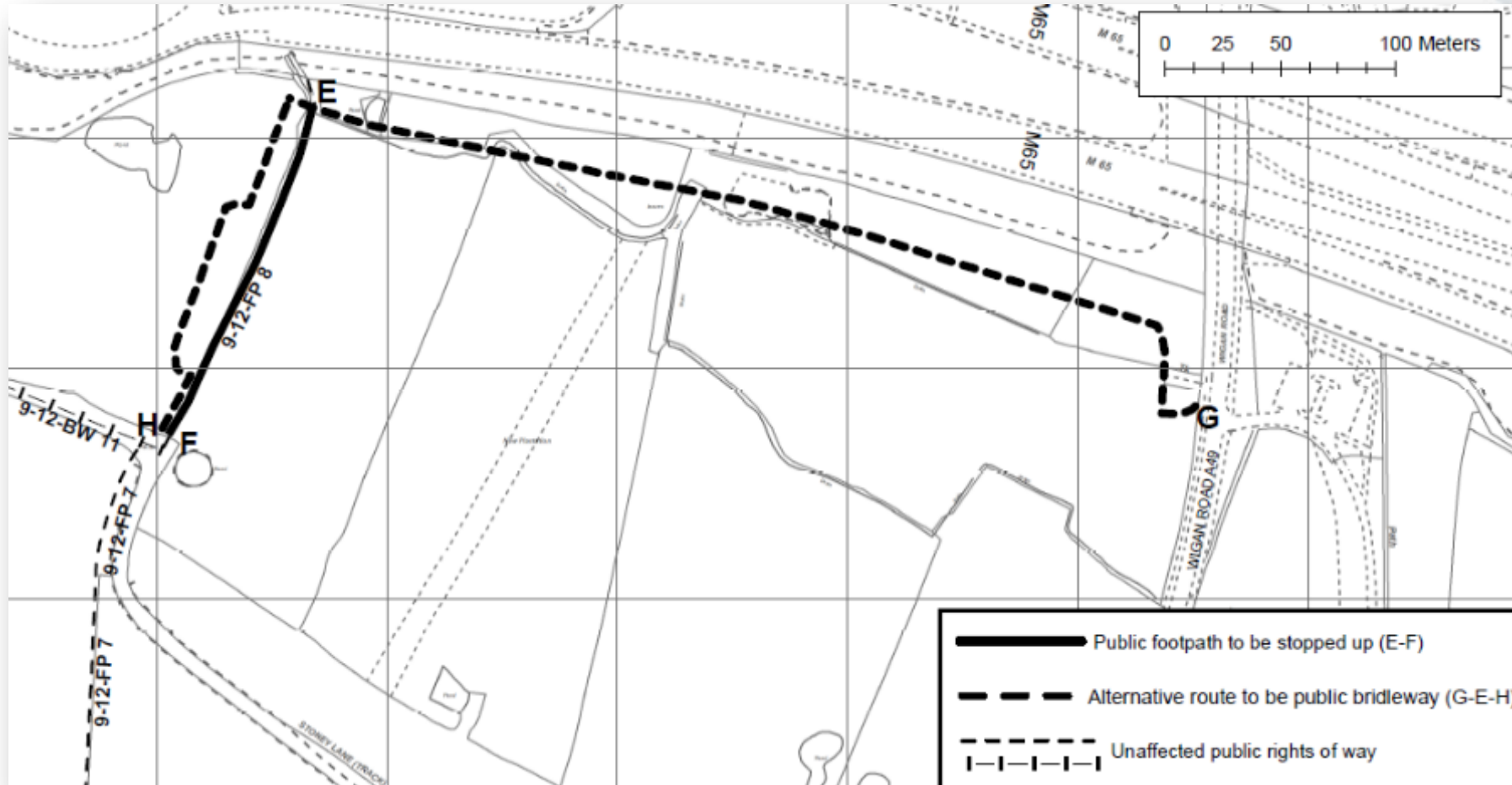

FP/2022/0001
Proposed diversion
of footpath 9-12-FP12

